



APPLICATION FOR LEASE RENEWAL



Lease Acronym	EASTW S1
Name of Leaseholder	Cooke Aquaculture USA Inc.
Name of Contact Person	Jennifer Robinson
Address	40 Barron Road
City	Eastport
State, Zip	Maine, 04631
Telephone	207-214-6009
Email	jennifer.robinson@cookeaqua.com
Term Requested	20 years

1. Describe the type and amount of aquaculture to be conducted during the new lease term:

Net pen cultivation of Atlantic Salmon on a 3 year rotation with periods of fallowing between harvesting and stocking.

2. Describe the amount of aquaculture conducted on the lease site during the previous lease term, including but not limited to seeding, cultivation or harvest of organisms:

Since the lease in 2013, the facility has been stocked on a 3 year rotation cycle, with Atlantic Salmon remaining on site through growout and harvest.

3. Suspended culture gear can attract birds that roost on the gear and defecate, potentially creating a pollution source impacting shellfish held within gear. In order to comply with the National Shellfish Sanitation Program (NSSP) Model Ordinance (MO), if the lease site is permitted for the culture of shellfish in suspended gear, please include a description of mitigation or deterrent measures to minimize the potential pollution impacts of birds at the lease site. If appropriate, include Sketches or photos that clearly depict those measures put into practice.

Examples may include:

- Suspended gear submerged at depth sufficient to deter roosting for at least two weeks before harvest
- Attaching physical deterrents (i.e. zip ties) to gear
- The lease site is used to culture shellfish seed only
- Only adductor-only shellfish are cultured on the lease site

N/A

RIPARIAN LANDOWNER LIST****THIS LIST MUST BE CERTIFIED****

On this list, please show the current landowners' names and mailing addresses as listed in the municipal tax records for all riparian shorefront parcels within 1,000 feet of the existing lease site along with the map and lot number for each parcel. **It is the applicant's responsibility to assemble the information for the Town Clerk to certify.** The Town Clerk *only* certifies that the information is correct according to the Town's records. Once you have completed the form, ask the Town Clerk to complete the certification section below. If the parcels are within more than one municipality, provide a separate, certified riparian list for each municipality.

TOWN OF:

MAP #	LOT #	Landowner name(s) and address(es)
2	68	Kevin Hamor 45 Scarpom Dr. Brunswick, ME 04011
2	67	LeBaron Sr. and Charlene Libby PO Box 154 Bears, ME 04611
2	67	Ivan and Rebecca Libby PO Box 118, 9 Old School Rd Bears, ME 04611
2	67	Glenn E. Libby PO Box 174 Jonesport, ME 04649
2	67	Norman Libby PO Box 140 Bears, ME 04611

Please use additional sheets if necessary and attach hereto.

CERTIFICATION

I, Terry L. Beal, Town Clerk for the Town of Bears certify that the names and addresses of the property owners listed above, as well as the map and lot numbers, are those listed in the records of this municipality and are current as of this date.

SIGNED: Terry L. Beal DATE: 8/15/23

4. Tax Maps and Riparian List

Is your existing lease within 1,000ft of shorefront land (which extends to mean low water or 1,650 ft. from shore, whichever is less, according to NOAA charts)?

Yes No

If yes, the following supporting documents are required:

A. Tax Map.

A labeled copy of the appropriate tax map(s) depicting the location of the proposed lease site.

The map(s) needs to include the following elements:

- Label the map "Tax Map: Town of (name of town)."
- Legible scale
- Tax lot numbers clearly displayed
- The boundaries of the existing lease

B. Riparian List.

Please use the Riparian Landowner List (included on the next page) to list the name and address of every shorefront landowner within 1,000 feet of your existing lease. Have the tax collector or clerk of the municipality certify the riparian list. Refer to the Riparian Determination guidance document to ensure all riparian landowners are included: <https://www.maine.gov/dmr/aquaculture/forms/documents/RiparianDetermination.pdf>

C. Check for \$1500 application fee

Signature of Leaseholder:

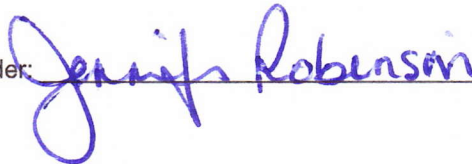

Date:

8/11/23

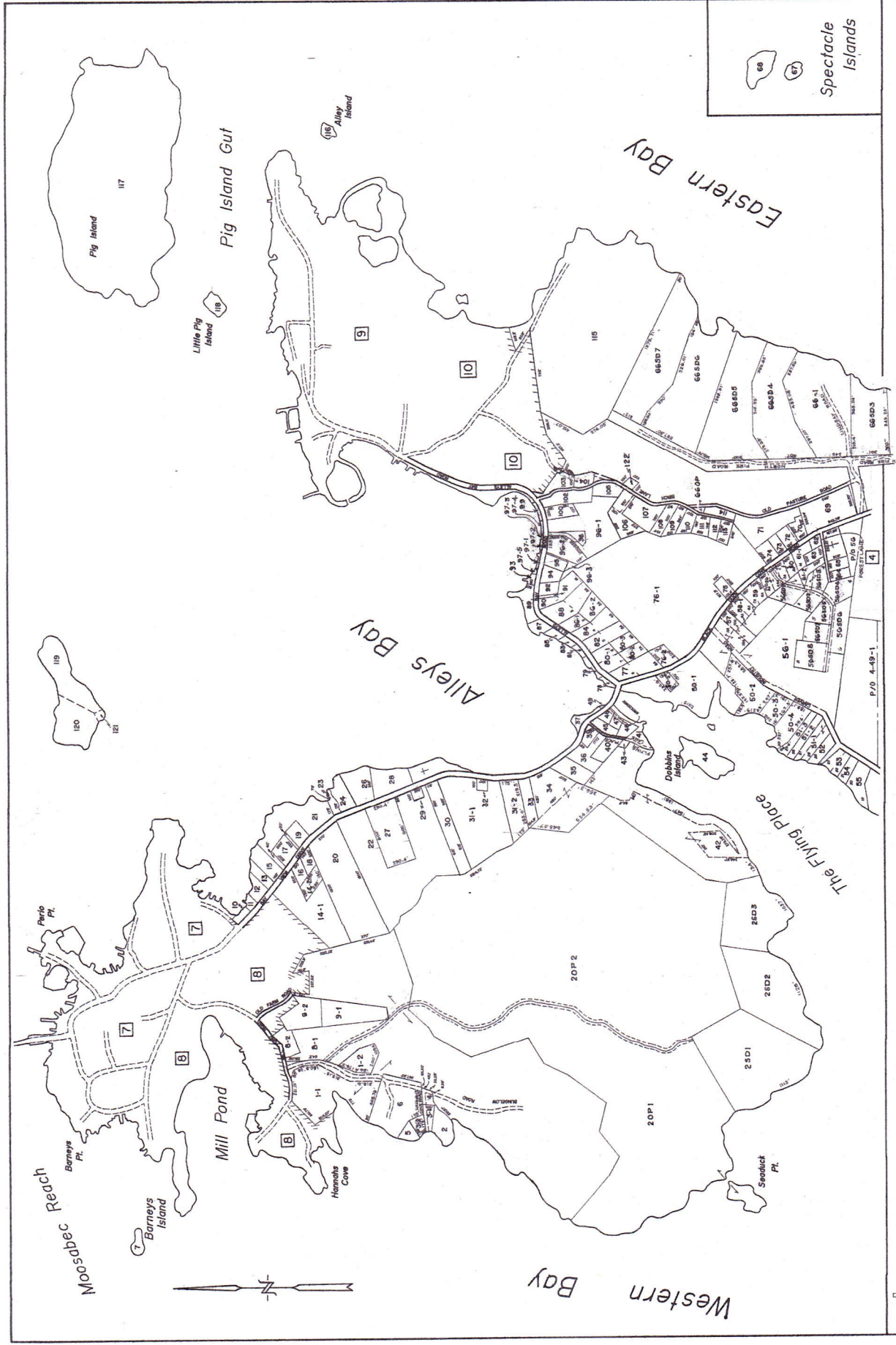

EMS
 EMERGENCY SERVICE
 6077 284-2777

TOWN OF BEALS
 WASHINGTON COUNTY, MAINE

TAX MAP
 MAP NUMBER **2**

LEGEND
 PARCEL NUMBER 2
 MATCHLINE 3
 ADJACENT MAPS 3

DATE OF AERIAL PHOTOGRAPHY APRIL 29, 1996
 DATE OF MAP COMPLETION APRIL 1998
 MAP SCALE 1 INCH = 500 FEET

THIS MAP AND ANY INFORMATION ARE FOR INFORMATIONAL PURPOSES ONLY. THE TOWN OF BEALS DOES NOT WARRANT THE ACCURACY OF THE INFORMATION CONTAINED HEREIN. THE TOWN OF BEALS IS NOT RESPONSIBLE FOR ANY DAMAGES, INCLUDING CONSEQUENTIAL DAMAGES, ARISING FROM THE USE OF THIS MAP OR ANY INFORMATION CONTAINED HEREIN.

SPECTACLE ISLAND

EASTW-SI
SPECTACLE ISLAND, ME, USA

SITE FEATURES

- MOORING/GRID/BRIBBLE LINES
 COMP BUOY 2000L
 100m NET PEN
 150ft GRID
 LEASE BOUNDARY
 1000ft LEASE OFFSET

ENVIRONMENT FEATURES

- BATHYMETRY (m)
 O.H.W.M.
 L.L.W.O.S.T
 LAND

LEASE BOUNDARY COORDINATES

- 01: 44.504250; -67.574439
 02: 44.503489; -67.573331
 03: 44.502089; -67.573111
 04: 44.501331; -67.576211

BATHYMETRIC DATA SOURCE

Novionics WebApp Chart

REVISIONS	###
DRAWN	AT
CHECK	FL
APPROVED	JR
REV. DATE	2023/08/17
PART NO.	N/A
SCALE	2023/08/17
STATUS	Draft

DRAWING TITLE
Spectacle Island Site Map

